

3

2

1

INTRALINK RELEASE LEVEL
MASS PRODUCTION
THIRD ANGLE PROJECTION

TOP VIEW

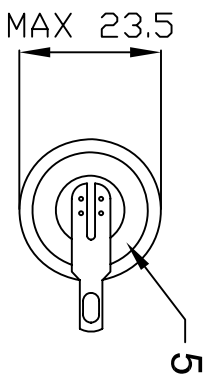

SIDE VIEW

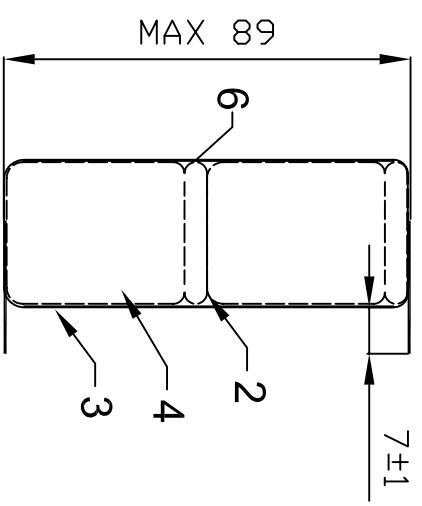

BOTTOM VIEW

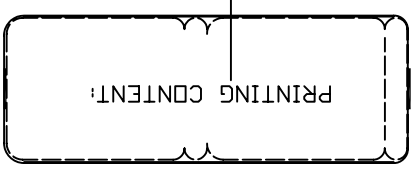
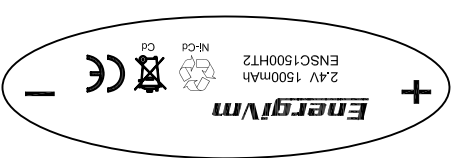
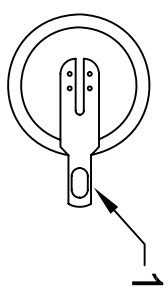

RIGHT VIEW

A2	INCREASED PRINTING CONTENT	18-12-10
A1	FIRST RELEASE	18-11-10
REV	CHANGE DETAIL	DATE

CAT: HIGH TEMP NICD RECHARGEABLE	REV. NO.: A2
DWG. NO.: BZ-0757	DESC: High Temp NICD Battery Pack (X2)
PART NO.: SC1500HT-S2S	
PAGE 1 OF 1	

SIGNATURES	DATE
DRAWN BY: ALAN FENG	18-12-10
CHECKED BY: RITA LIN	18-12-10
APPROVED BY: SIMON TANG	18-12-10

REF	DESCRIPTION	QTY	REMARKS
6	PAPER CYLINDER	1	SCX2
5	SINGLE CELL INSULATION PLATE	2	WHITE
4	SINGLE CELL	2	SC1500HT
3	BATTERY PACK PVC	1	WHITE
2	CONNECTION TAB	1	
1	OUTPUT TERMINAL	2	YCP-042

NOTE:
 1. NOT TO SCALE
 2. ALL DIMENSIONS IN MM
 3. ALL TOLERANCES ARE +/- 0.5MM UNLESS OTHERWISE SPECIFIED

This document contains Great Energy proprietary data, and is not to be copied, reproduced, used or divulged to unauthorized persons, in whole or in part, without proper authorization in writing from Great Energy. This information is the property of Great Energy which reserves all rights to it.

A

B

C

3

2

1

A

B

C